



Range of heights – 42U and 47U

Range of widths – 600 and 800mm

Depth – 1000mm

Full width vented front door

Wardrobe vented rear doors

High security 3 point locking on front and rear doors

Built in telescopic stabilising plinth

Load carrying capacity 800kg

Features

- Available from stock in 2 heights – 42 and 47U
- Built in telescopic stabilising plinth
- High load bearing design – 1000kg
- In excess of 70% venting on front doors
- Space saving wardrobe style rear doors
- High security 3 point locking as standard
- Wide range of power management and ventilation accessories

Product Overview

The Excel Server+ range is designed for the safe and secure housing of network and server equipment. Available in two heights – 42 and 47U – and a choice of either 600 and 800mm widths, Server+ is ideal for mid size server rooms through to multi rack datacenter installations. The welded frame construction creates an extremely strong, yet versatile cabinet.

Part of the family of Excel floor standing cabinets, Server+ is packed with design features which allow for ease of use and pleasing aesthetics. Key elements include strength and air flow / ventilation management. Easy access to equipment is also assured due to quick release side panels, and front and rear doors mounted with quick release spring loaded hinge pins.

Each rack consists of two sets of heavy duty full height 19" mounting profiles, which can be adjusted throughout the depth of the cabinet, between these profiles are four sets of front to rear strength members. This simple yet efficient design, creates an extremely rigid frame capable of carrying upto 1000kg of equipment.

The front door is a full width metal style panel, perforated with hexagonal cut outs to provide a highly vented finish. The stylish swing style handle incorporates a three point lock – fastening into the side, top and bottom of the frame – to provide maximum security.

To the rear of the rack are a pair of vented doors, opening in wardrobe style saving space, and allowing quick and easy access, as with the front door, three point locking is standard.

To minimise the weight and size of the removable side panels the Server+ range is designed with a two piece panel, the removable side panel is 688mm deep allowing ample access to equipment as required

To assist in the safe and easy maintenance and use of equipment mounted within the cabinet, the standard specification of each each Server+ rack includes a telescopic stabilising plinth. Also in the base of the cabinet is a sliding panel to allow for cable access as required, jacking feet are included as standard.

Exploded View

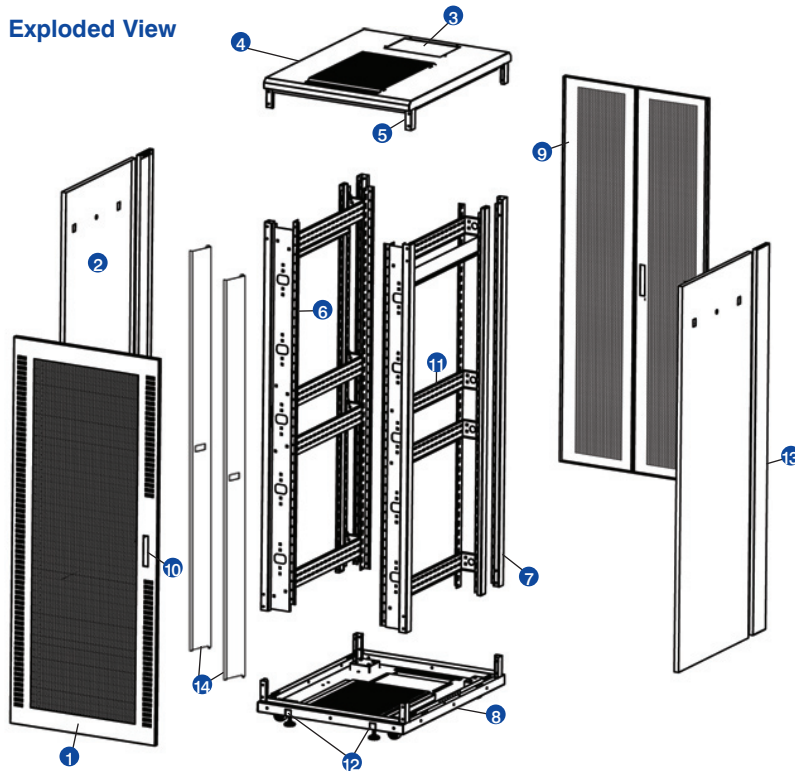

- 1 Front door
- 2 Side panel
- 3 Roof panel, removeable entry plates
- 4 Roof panel
- 5 Upper frame
- 6 Mounting profile
- 7 Corner post
- 8 Lower frame
- 9 Rear door
- 10 Swing lock handle
- 11 Horizontal supporting bars
- 12 Telescopic stabilising plinth
- 13 Side infill panel
- 14 Vertical cover plates (800mm width only)

Sectional Views

Front View

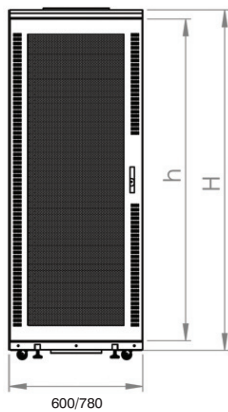

Side View

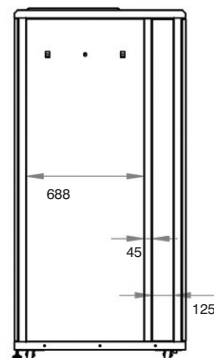

Rear View

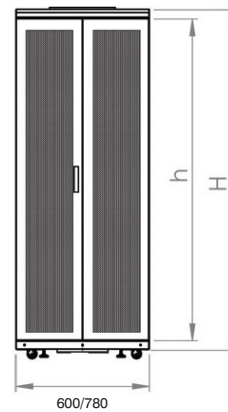

Plan View

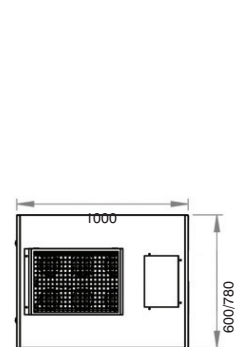

42u	inside height (h)	1899mm
	overall height (H)	2049mm
47u	inside height (h)	2122.15mm
	overall height (H)	2272.15mm

NB: The maximum depth 19" profiles can be set up is 740mm Should you need to fit cable trays to the Server+ cabinet series no adaptor plates are required
All dimensions are shown in mm

Product Specification

Material Thickness

Cabinet Part	Thickness
Upper and Lower Case	2.0mm
Top cover and fan entry plate	1.0mm
19" mounting angles	2.0mm
Front and rear doors	1.2mm
Side Panels	1.2mm
Side extension panel	1.0mm
Frame	2.0mm
Front to rear support rails	2.0mm

Product Standard Compliance

Process/Part	Standard
Manufacturing facility	ISO9001:2000
19" mounting angles	IEC297-1
Overall cabinet dimensions	IEC297-2
Load carrying capacity	1000kg
Paint finish	Ral 9005
Surface treatment	Fosfat coating
IP protection	IP30

Perforation Detail

- Percentage Ventilation of Door Panel

Cabinet	Front Door Full Width	Rear Door Wardrobe
42U 600mm wide	73%	46%
42U 800mm wide	77%	58%
47U 600mm wide	72%	45%
47U 800mm wide	76%	57%

Product Features



- Wardrobe vented rear doors (image shows door fitted with full height 6 unit fan tray)



- Four full depth strength bars



- Clearly identified U height marking on front and rear profiles



- Adjustable 19" mounting profiles



- Vented front door, lockable side panel



- Quick release hinge pins on doors



- Easy to handle, removable side panel



- High security 3 point locking as standard

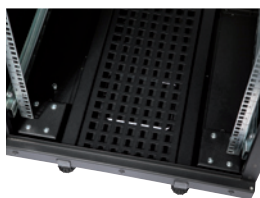

- Sliding panel at base allows cable access



- Telescopic stabilising plinth fitted as standard

Part Number Information

U Size	Width (mm)	Overall Height (mm)	Depth (mm)	Part Number - Assembled
42	600	2049	1000	540-501-BK
47	600	2272	1000	540-503-BK
42	800	2049	1000	540-502-BK
47	800	2272	1000	540-504-BK

Note: For overall height when using jacking feet please add 30mm
For overall height when using castors please add 75mm

All server cabinets are black

Other cabinet sizes can be supplied subject to manufacturing lead times and minimum order quantities, please contact your local Excel sales office.

For the range of accessories available for the Server+ Series, please see the cabinet brochure or visit the online catalogue.

Also available are Excel cabling racks, equipment racks, wall mounted cabinets and a full range of power distribution units.



Virtware - Sol. Int. Telecomunicações, Lda
Rua dos Canastreiros, 394
4400-404 Canidelo VNG, Portugal

Tel: +351 918205881
Email: info@virtware.pt Web: www.virtware.pt