

25 Year System Warranty

Singlemode & Multimode

Dust Caps Included

Features

- Singlemode versions
- Multimode versions
- ST, SC, LC, FC versions
- Dust Caps Included
- 25 Year System Warranty

Product Overview

Excel fibre optic adaptors have been designed to present a range of optic fibre connectors. The adaptors are constructed to allow fitting in the bulkheads either with a nut or with clips. The housings are manufactured from a range of plastics and metals selected to provide the optimum performance.

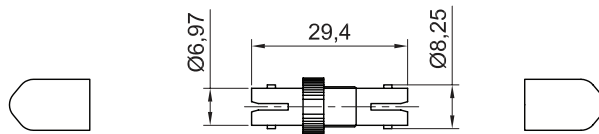

ST - Plan View

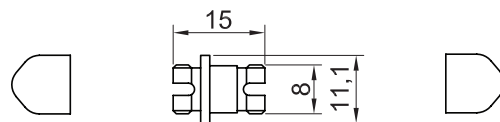

FC - Plan View

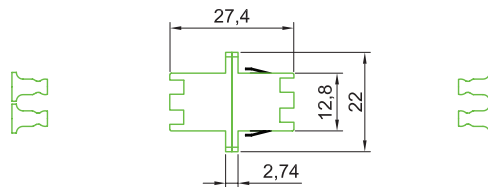

SC Simplex - Plan View

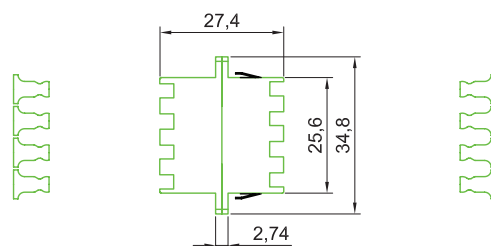

SC Duplex - Plan View

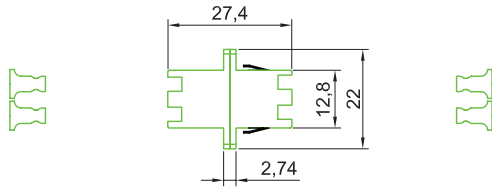

LC Duplex - Plan View

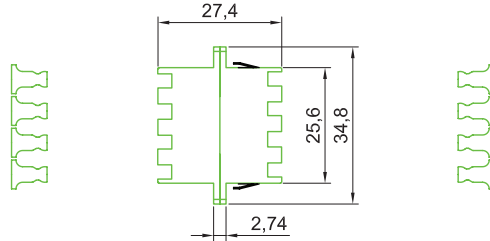

LC Quad - Plan View

Operating Performance

| | |
|-------------------------|---------------------|
| Insertion Loss | < 0.2 dB |
| Durability (500 Mating) | 0.2 dB Max Increase |
| Operating Temperature | -40°C to +80°C |
| Retention Force | 200 – 600 grams |

System Warranty

When installed with Excel Fibre Cables and Components by an accredited Excel cabling partner this product is supported by a comprehensive 25 year product & applications warranty.

Part Number Information

| Part No. | Description |
|-------------|---------------------------|
| 200-350 | ST Simplex Multimode |
| 200-389 | FC Multimode |
| 200-570 | SC Simplex Multimode |
| 200-365 | SC Duplex Multimode |
| 200-363-BRO | LC Duplex Multimode |
| 200-568 | LC Quad Multimode |
| 200-735 | ST-SC Duplex Multimode |
| 200-350-SM | ST Simplex Singlemode |
| 200-390 | FC Singlemode |
| 200-571 | SC Simplex Singlemode |
| 200-366 | SC Duplex Singlemode |
| 200-364 | LC Duplex Singlemode |
| 200-569 | LC Quad Singlemode |
| 200-566 | SC APC Simplex Singlemode |
| 200-567 | SC APC Duplex Singlemode |

Other adaptors are available. Contact the local Excel distributor.



Virtware - Sol. Int. Telecomunicações, Lda
 Rua dos Canasteiros, 394
 4400-404 Canidelo VNG, Portugal

Tel: +351 918205881
 Email: info@virtware.pt Web: www.virtware.pt